

**JUNIPER**  
**SF55525**  
 SEMI FLUSH

PROJECT



SF55525-BG/OP  
 Brushed Gold/Opal  
 Matte Glass



SF55525-BK/OP  
 Black/Opal Matte  
 Glass

**SPECIFICATION DETAILS**

<b>Fixture Dimensions</b>	L24-1/4" x W7-3/8" x H15-5/8"
<b>Light Source</b>	LED with DC Driver
<b>Wattage</b>	22W
<b>Total Lumens</b>	1530lm*
<b>Delivered Lumens</b>	BG/OP-1150lm*; BK/OP-1050lm*; Apply
<b>Voltage</b>	120V
<b>Color Temperature</b>	3000K
<b>CRI (Ra)</b>	90CRI
<b>Optional Color Temps</b>	2700K - 5000K Available, Minimum Order Quantities Apply
<b>LED Rated Life</b>	50,000 hours
<b>Dimming</b>	100% - 10%, TRIAC or ELV Dimmer (Not Included)
<b>Glass Details</b>	Opal Glass
<b>Minimum Hang Height</b>	8-3/8"
<b>Location</b>	Dry
<b>Illumination Direction</b>	Omni-directional
<b>CEC Title 24 JA8</b>	Yes, JA8-2022
<b>Canopy Dimensions</b>	D5-1/8" x H1-1/4"
<b>Material</b>	Steel + Aluminum + Glass
<b>Paint Finish</b>	BG01; BK01;

\* For custom options, consult factory for details.

\* For warranty information, please visit [www.kuzcolighting.com/warranty](http://www.kuzcolighting.com/warranty)

**DESCRIPTION**

Juniper's shape expands and contracts to suit your space's needs. Each branch of the Juniper collection adjusts to lengthen or collapse, creating a customized look. Atop each arm sits three growing Matte Opal glass globes stretching outwards to create depth and emphasis.

- Adjustable arms to create varied styles
- Matte Opal glass globes
- LED, no need for bulbs
- Matte Black or Brushed Gold finishes

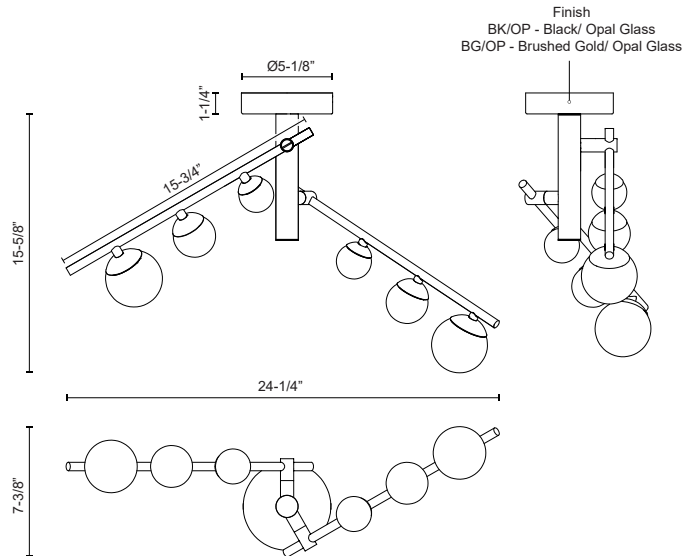

**KUZCO**

CANADA: 19054 28TH AVENUE - SURREY, BC V3Z 6M3  
 USA: 3035 E. LONE MOUNTAIN ROAD - LAS VEGAS, NV 89081

[WWW.KUZCOLIGHTING.COM](http://WWW.KUZCOLIGHTING.COM)

© 2024 KUZCO LIGHTING. ALL RIGHTS RESERVED.

**COMMENT**

